

SITE DATA (AREA A)

ANCHOR A	43,810 S.F.
ANCHOR B	26,310 S.F.
SHOPS C	4,875 S.F.
TOTAL BUILDING AREA	77,125 S.F.
STANDARD STALLS PROVIDED:	405 STALLS
COMPACT STALLS PROVIDED:	0 STALLS
ACCESSIBLE STALLS PROVIDED:	8 STALLS
TOTAL PARKING PROVIDED:	413 STALLS
PARKING RATIO:	5.38 / 10,000 S.F.
TOTAL BUILDING ADDITION:	77,125 S.F.

SITE DATA (AREA B)

ANCHOR D	15,700 S.F.
ANCHOR E	7,000 S.F.
ANCHOR F	12,500 S.F.
SHOPS G	2,250 S.F.
PAD 'I'	6,000 S.F.
PAD 'Z'	3,480 S.F.
TOTAL BUILDING AREA	53,230 S.F.
STANDARD STALLS PROVIDED:	198 STALLS
COMPACT STALLS PROVIDED:	0 STALLS
ACCESSIBLE STALLS PROVIDED:	6 STALLS
TOTAL PARKING PROVIDED:	206 STALLS
PARKING RATIO:	3.87 / 10,000 S.F.
TOTAL BUILDING ADDITION:	53,230 S.F.

OVERALL SITE DATA

ANCHOR A	45,600 S.F.
ANCHOR B	24,410 S.F.
SHOPS C	4,875 S.F.
ANCHOR D	15,700 S.F.
ANCHOR E	7,000 S.F.
ANCHOR F	15,500 S.F.
SHOPS G	2,250 S.F.
PAD 'I'	6,000 S.F.
PAD 'Z'	3,480 S.F.
TOTAL BUILDING AREA	128,735 S.F.
STANDARD STALLS PROVIDED:	603 STALLS
COMPACT STALLS PROVIDED:	0 STALLS
ACCESSIBLE STALLS PROVIDED:	16 STALLS
TOTAL PARKING PROVIDED:	619 STALLS
PARKING RATIO:	4.90 / 10,000 S.F.

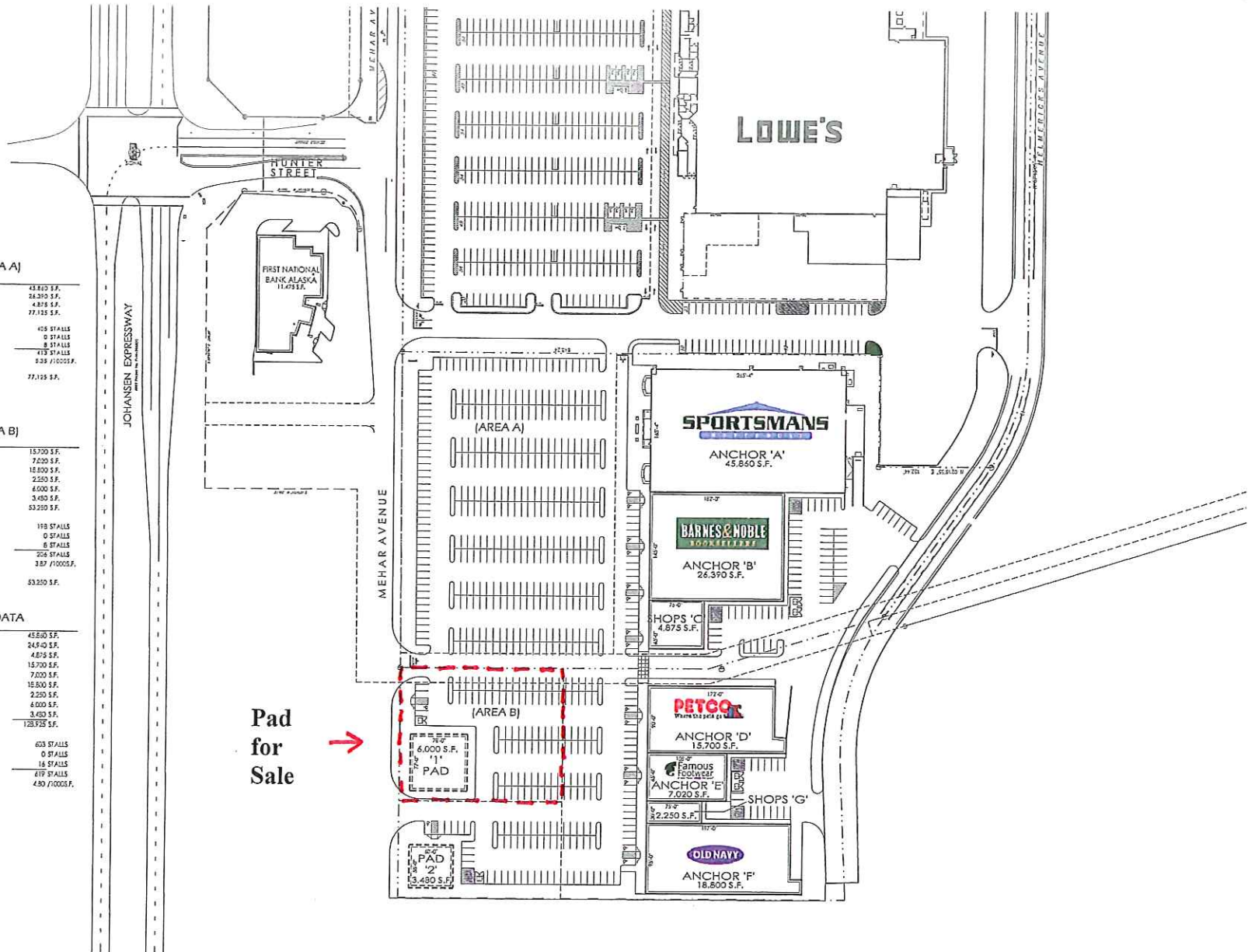

SITE PLAN
SCALE: 1" = 50'

FAIRBANKS RETAIL
FAIRBANKS, ALASKA



File Path: P:\23114\Site Dev\23114653.dwg

POB MONTGOMERY & CO